



Hitachi (Metric and imperial)



445002 - EUR Threaded nut (M14) x 15mm long

556008 - USA Threaded nut (5/8"-11) x 15mm (5/8") long

DEWALT (metric & imperial)



556004 - EUR Threaded nut (M14) x 19mm long

556009 - USA Threaded nut (5/8"-11) x 19mm (3/4") long

Makita (metric & imperial)

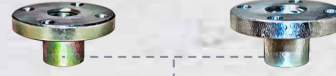

445002 - EUR Threaded nut (M14) x 15mm long

556008 - USA Threaded nut (5/8"-11) x 15mm (5/8") long

FLEX (metric & imperial)



556004 - EUR Threaded nut (M14) x 19mm long

556009 - USA Threaded nut (5/8"-11) x 19mm (3/4") long

Milwaukee (metric & imperial)



445002 - EUR Threaded nut (M14) x 15mm long

556008 - USA Threaded nut (5/8"-11) x 15mm (5/8") long



Diamond Cup grinder wheel



556021 - Distance Spacer w lip 15mm



Original Hitachi drive spacer with key



555013 - Distance Spacer w lip 20mm



Original Dewalt drive spacer with key



556021 - Distance Spacer w lip 15mm



Original Makita drive spacer with key



555013 - Distance Spacer w lip 20mm



Original FLEX drive spacer with key



556021 - Distance Spacer w lip 15mm



Original Milwaukee drive spacer with key

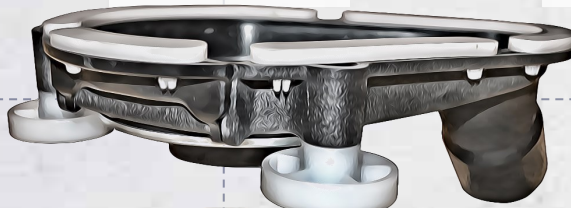

556015 - Collar H11 (Hitachi)



556016 - Collar DE1 (Dewalt)



556014 - Collar MA1 (Makita)



556018 - Collar BO1



556006 - Collar MT2 Metabo (WX24-230 Quick)#



556019 - Collar MIL1 Milwaukee (AGV12-125XPD)



Metabo (metric & imperial)

BOSCH (metric & imperial)

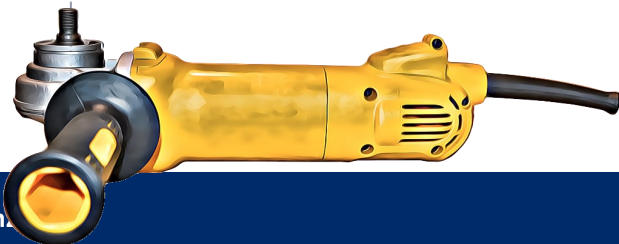

Spare parts / replaceable

